

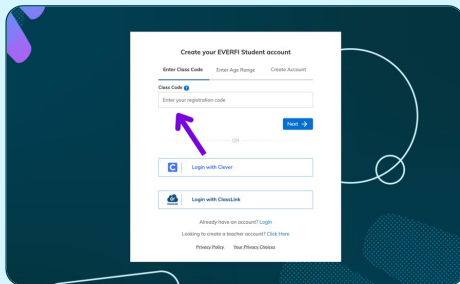

Quick Start Guide for students

Visit EVERFI.com/Student to begin

1



ENTER YOUR CLASS CODE

In your web browser, visit EVERFI.com/Student and enter your unique class registration code from your teacher.

2

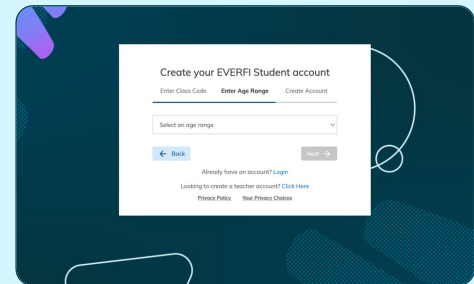

CREATE YOUR ACCOUNT

Select your age range and then click “Next.” To complete your setup, create a username and password. Now click “Create Account.” You’re in!

3

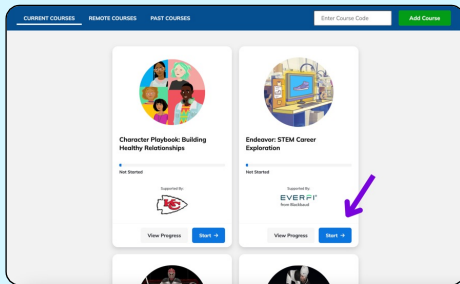

GET STARTED

Click “Start” on the course your teacher has assigned. Make sure your volume is on throughout the course.

4

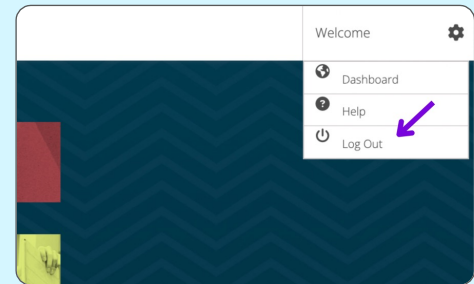

NEXT TIME

When your class is over, go to the Settings icon on the top right corner of your screen and click “Log Out.” Your progress will be saved. Next time, log back in at EVERFI.com/Login.

